

Maintenance

Engine Oil And Filter Change

NOTE: Change engine oil with the engine warm and the motorcycle on its center stand to assure complete and rapid draining.

Stop the engine.

Remove the oil filler cap, drain plug, oil filter bolt, and oil filter cover.

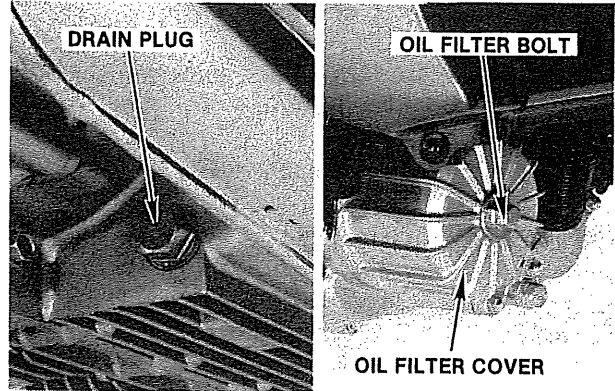

After draining the oil completely, check that the drain plug sealing washer is in good condition, and install the plug.

Replace the oil filter. Check that the oil filter bolt and cover O-rings are in good condition.

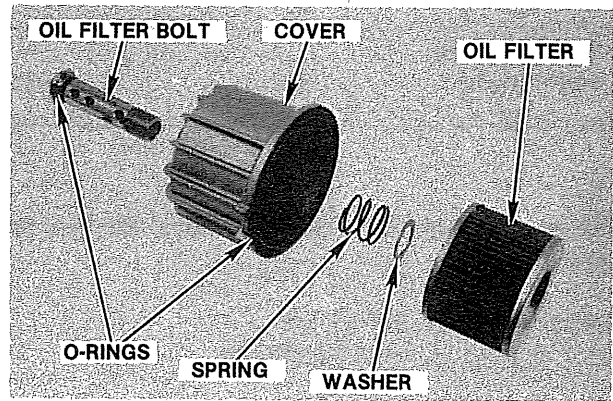

Install the filter cover, positioning the two cover tabs on either side of the boss on the water pump cover.

Fill the crankcase with approximately 3.2 liters (3.4 U.S. quarts) of the recommended grade oil and install the oil filler cap.

Recommended Oil: Honda 4-Stroke Oil or Equivalent
API Service Classification: SE or SF
Viscosity: SAE 10W-40

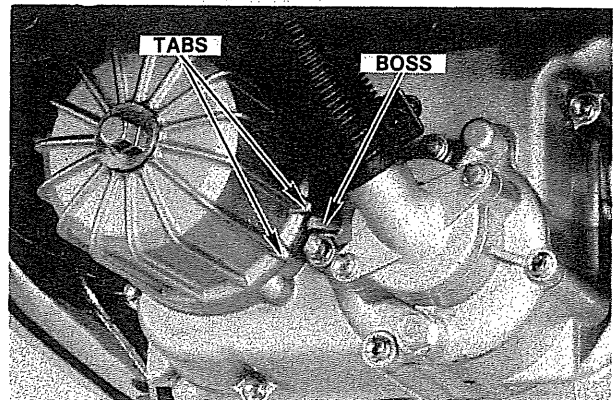

Other viscosities shown in the chart may be used when the average temperature is within the indicated range.

Recommended Oil Viscosity

