

THIS DRAWING MAY BE FREELY USED OR MODIFIED FOR ANY NON-PROFIT OR NON-COMMERCIAL USE. ALL ACCURACY AND SAFETY ISSUES ARE THE USERS RESPONSIBILITY. THE ORIGINATOR AND THE PROVIDER ARE NOT RESPONSIBLE OR LIABLE FOR ANY LOSSES OR DAMAGES INCURRED FROM THE CREATION OR USE OF THE PRODUCTS CONTAINED IN THIS DRAWING.

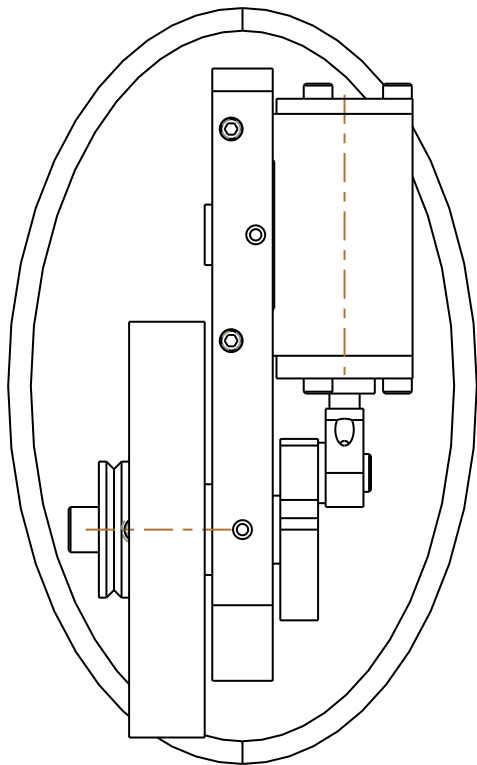

ITEM NO.	DWG NO.	DESCRIPTION	MATERIAL	SIZE	NOTES	QN'TY
1	1	MANIFOLD BLOCK	MILD STEEL			1
2	2	BASE PLATE	H.T. AL.			1
3	3	CRANKSHAFT	SILVER STEEL			1
4	4	CYLINDER	CAST IRON			1
5	5	ROD GLAND	BRASS			1
6	6	CYL. HEAD	BRASS			1
7	7	FLYWHEEL	BRASS			1
8	8	PISTON	CAST IRON			1
9	9	PISTON ROD	SILVER STEEL			1
10	10	BIG END BEARING	BRASS			1
11	11	ATTR. TRUNNION	SILVER STEEL			1
12	12	RARE EARTH MAGNET	NEODEY./IRON/BORON			1
13	1	BUSHING	BRONZE	6X8X8		1
14	1	BUSHING	BRONZE	8X10X8		1
15		SET SCREW	STK.	M3 X 3		4
16	3	CRANK PIN	SILVER STEEL			1
17		S.H.C.S.	STK.	M2 X 6 LG.		6
18	5	GLAND COVER	BRASS			1
19	5	O-RING	VITON	1X4		1
20		S.H.C.S.	STK.	M2 X 5 LG.		1
21		S.H.C.S.	STK.	M4X10		2
22		SET SCREW	STK.	M4 X 6		1

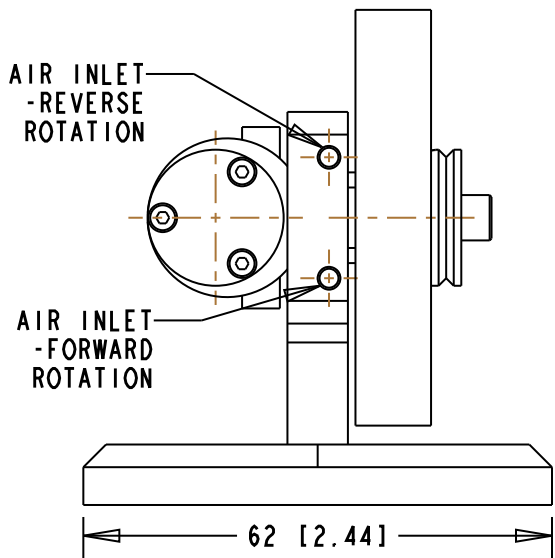
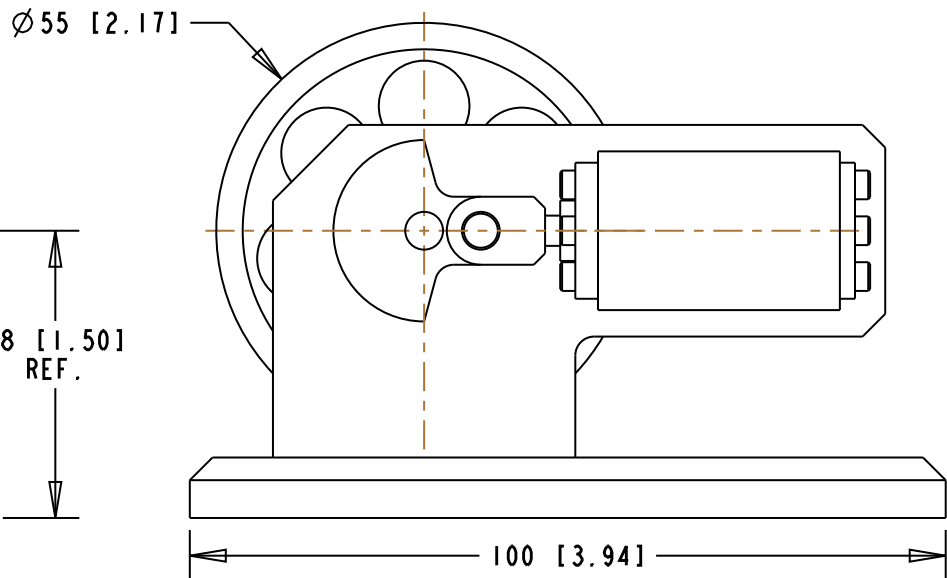
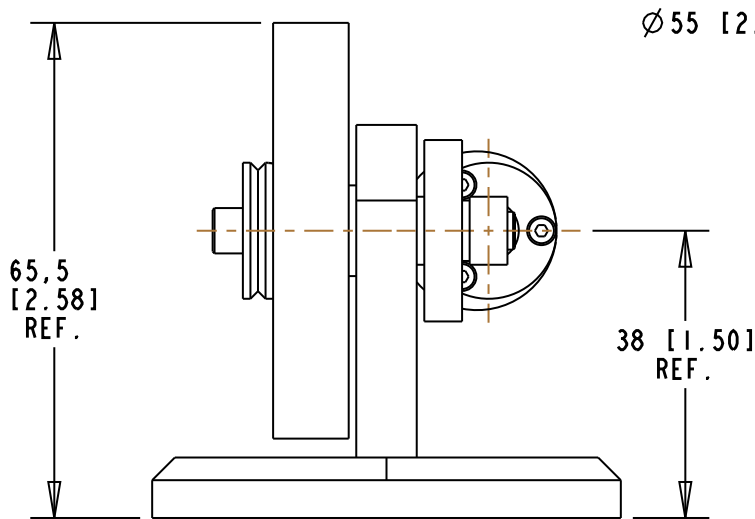

10MM BORE
15MM STROKE
DOUBLE ACTING
AIR ENGINE

SEE "WOBBLE1" DRAWING FOR
PART DETAILS/ADDITIONAL NOTES

REV.	DATE	DESCRIPTION
0	12-12-20	



SCALE 1.000

GENERAL TOLERANCES UNLESS NOTED				KEN I's MAGNETICALLY			
.XXX .XX ANGLES				SPRUNG WOBBLER ENGINE			
DRAWN:		DATE	12-12-20	SIZE	DRAWING NAME		
CHECKED:		DATE		B	WOBBLER ASSY.		
				SCALE:	AS SHOWN	DWG. NO.:	SHEET 1 OF 2

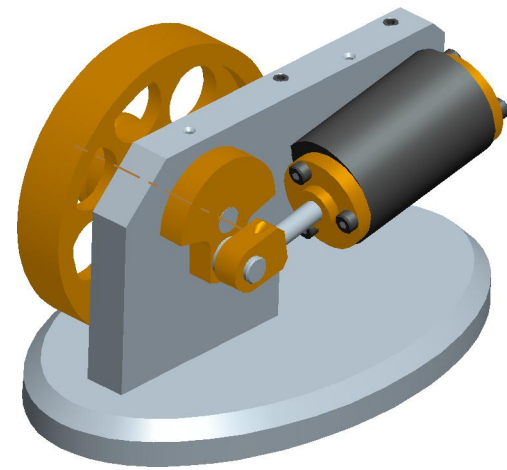

SCALE 0.750

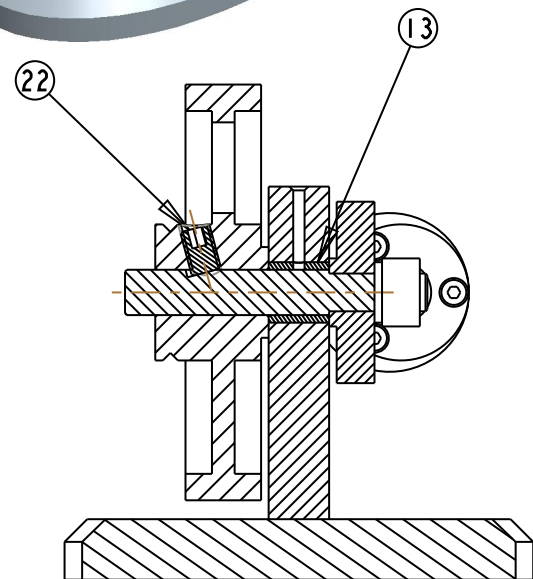
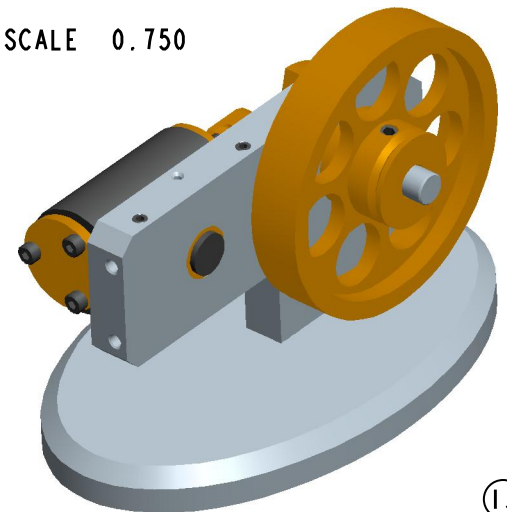

SECTION B-B

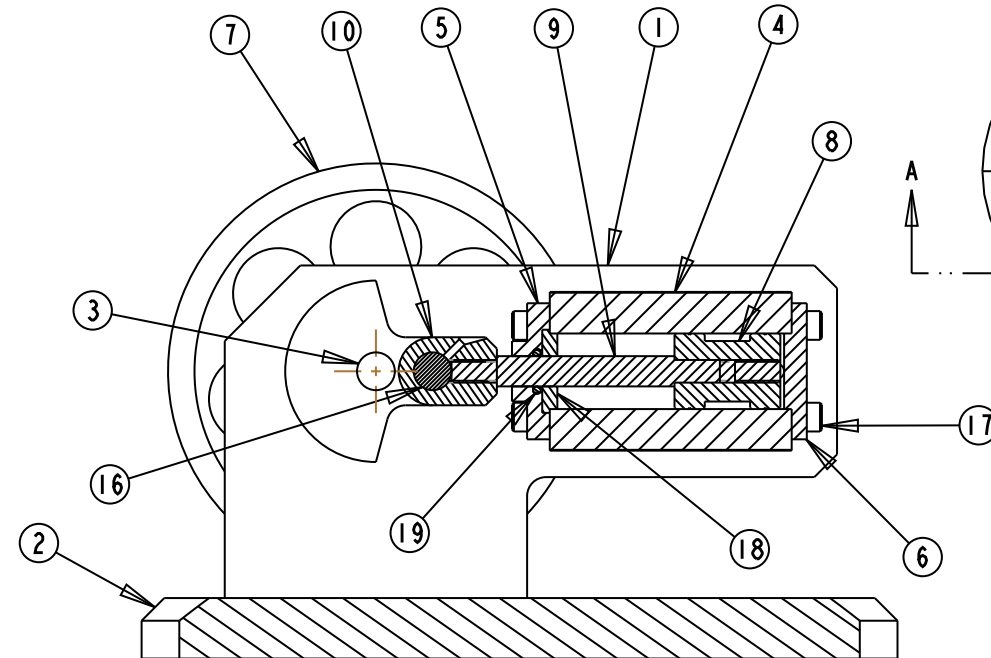

SECTION A-A

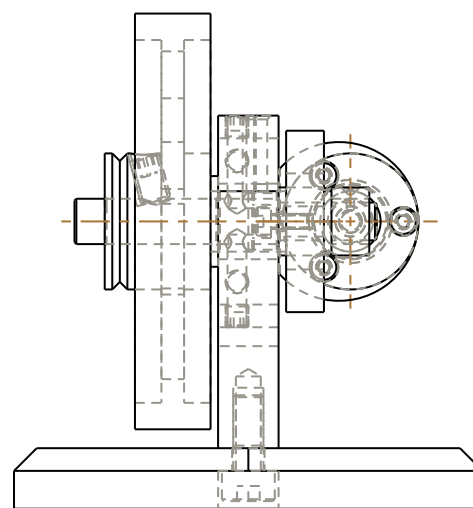

SCALE 1.000

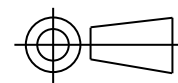

THIRD ANGLE PROJECTION

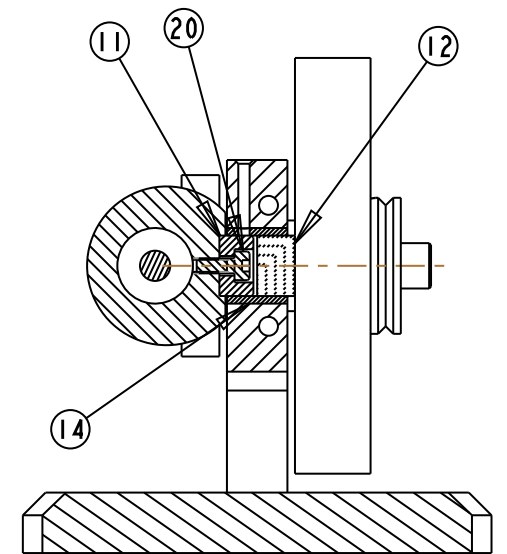
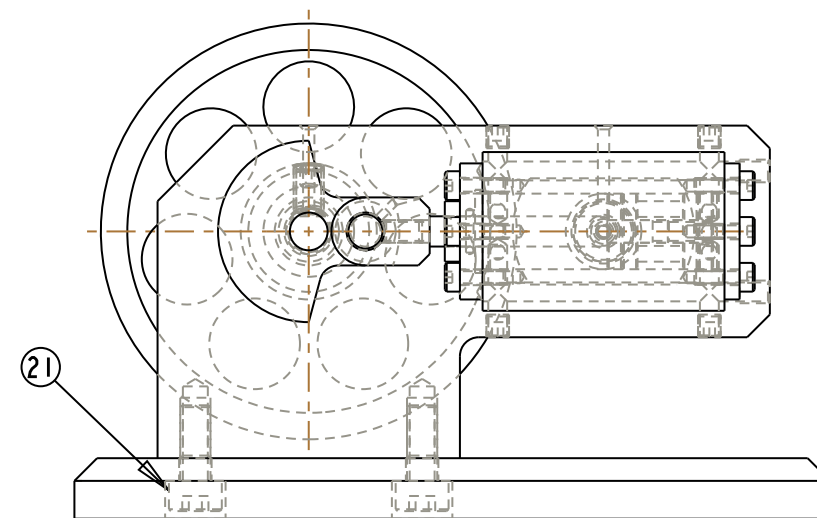
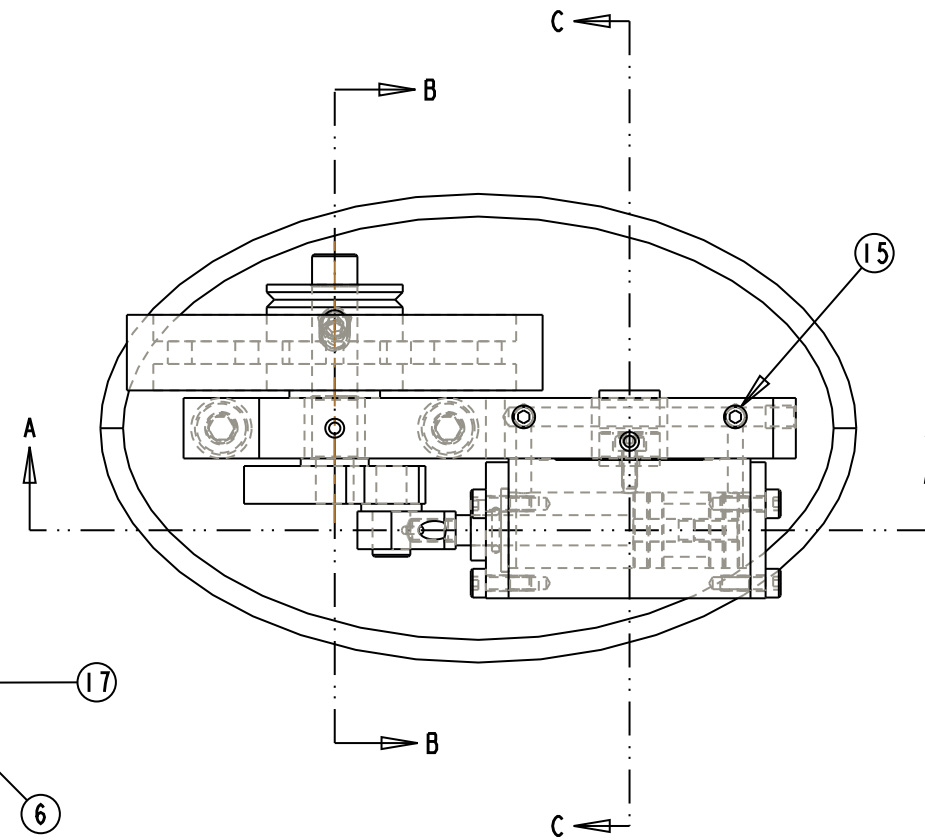

SECTION C-C

SEE "WOBBLE1" DRAWING FOR
PART DETAILS/ADDITIONAL NOTES

REV.	DATE	DESCRIPTION
0	12-12-20	

GENERAL TOLERANCES UNLESS NOTED				KEN I's MAGNETICALLY			
.XXX .XX ANGLES				SPRUNG WOBBLER ENGINE			
DRAWN:		JCM	DATE	12-12-20	SIZE	DRAWING NAME	
CHECKED:			DATE		B	WOBBLER ASSY.	
					SCALE: AS SHOWN	DWG. NO.:	
						SHEET	2 OF 2