



IMPORTANT NOTICE

Savage Arms uses two different models of bolt release.

- Side bolt release (Picture A on page 2)
- Bottom bolt release (Picture B on page 2)

Cadex chose to optimize its design to fit the side release model which is the most popular model. Our chassis can fit both style of bolt release but for the bottom release model you may need to use a small object (a pen, a Allen key, etc) to push on the bottom release while pulling on the trigger in order to remove your bolt from the action (Picture C on page 3)

All Cadex chassis fit the 2006 to current generation 4.40" action screw spacing. If you own a blind magazine model make sure that your rifle is not older than 2006.

If you own a Savage Arms 204 Ruger or 223 Rem make sure to specify that it is for a 223 Rem model in order to receive a different detachable base than the standard model. If you do not specify this detail you will receive the standard detachable base (308 Win) and it will not fit your action model. There's no extra charge for this special detachable base.

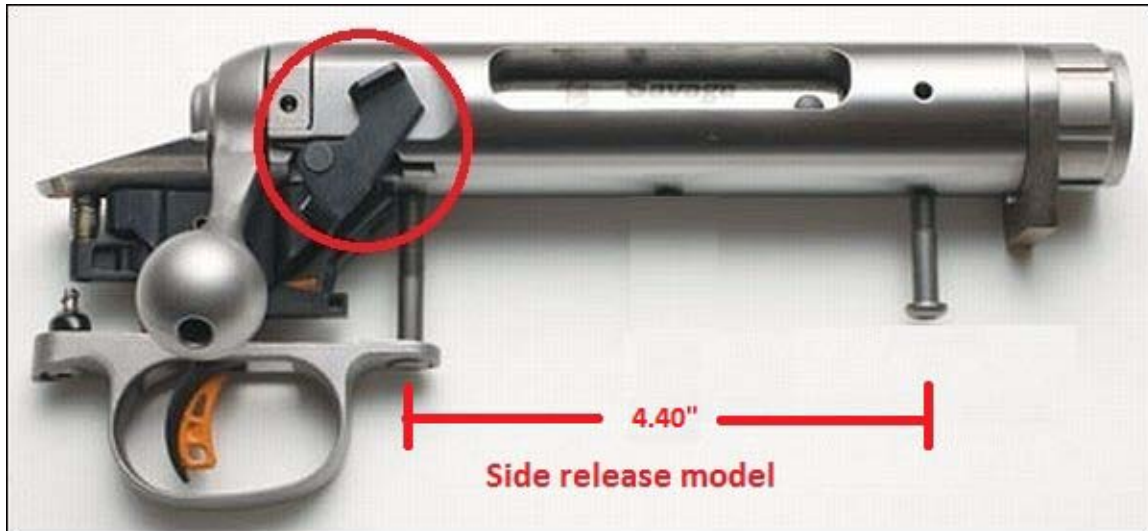

Picture A

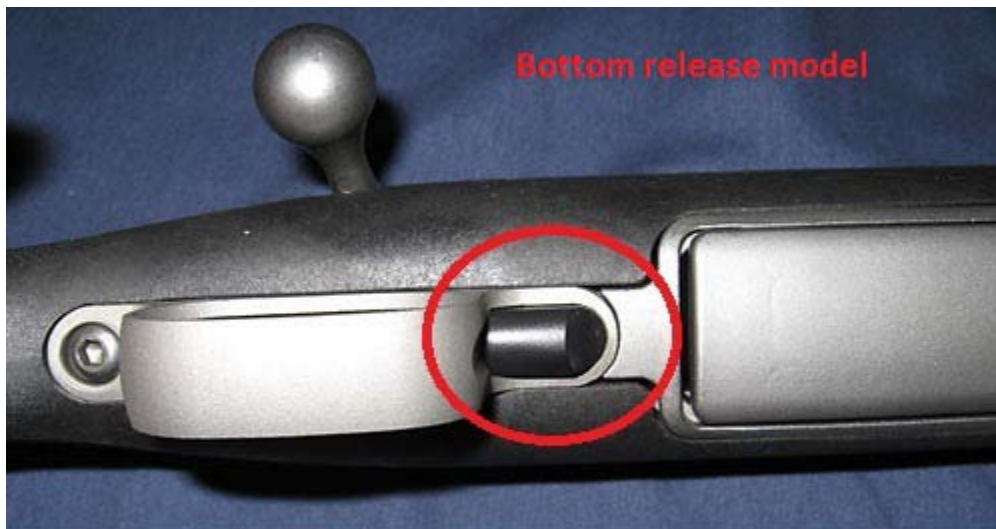

Picture B



Will fit our chassis but to remove the action bolt you will need to use a pointed tip tool to push on the factory lever.

Picture C